

# Rural Municipality of Weyburn No. 67

## ZONING DISTRICT MAP

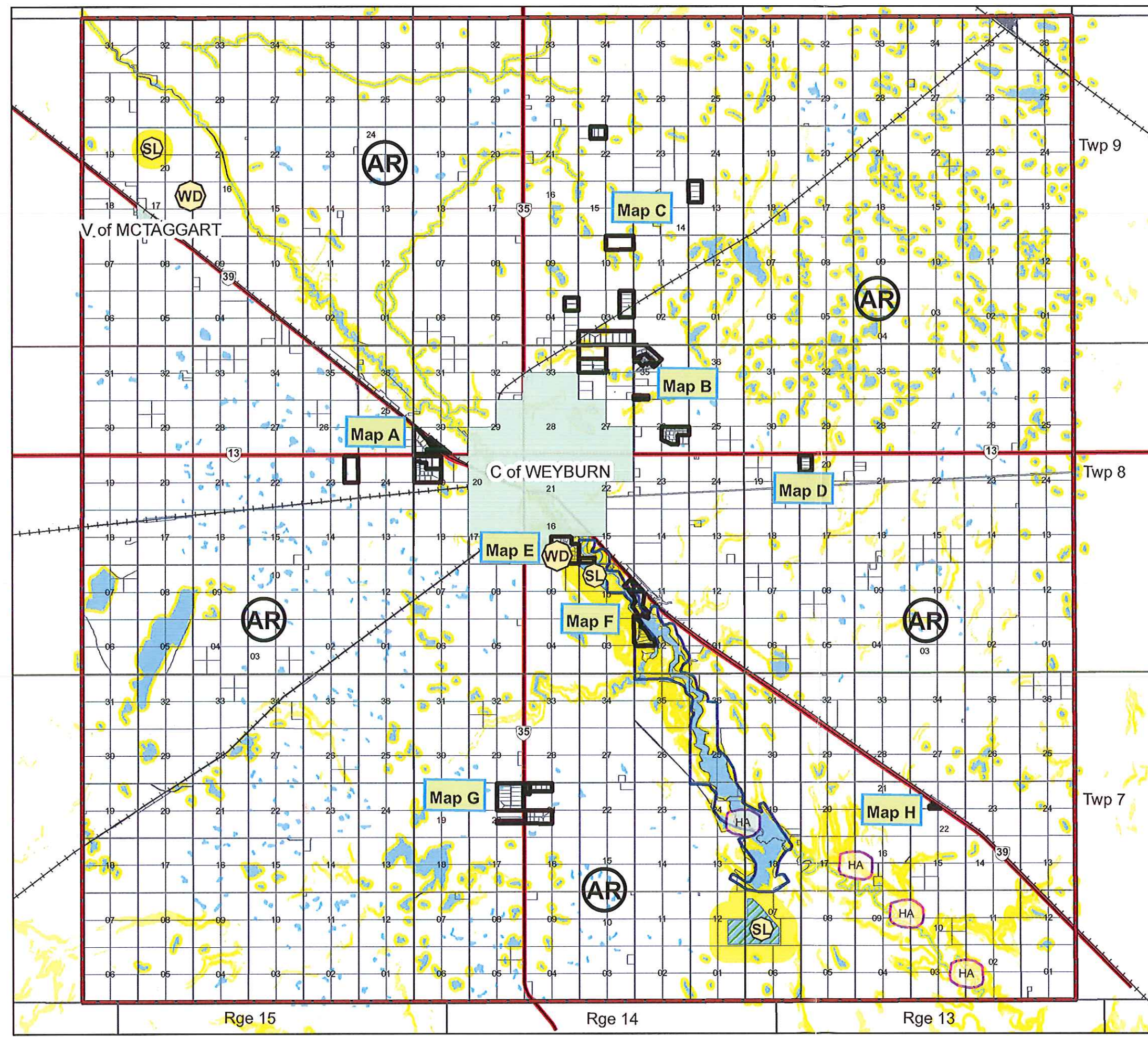

- ++++ Railways
- ▭ Municipal Boundary
- ▭ Urban Municipality
- ▭ Waterbody-Drainage
- ▨ Sewage Lagoons
- ⬭ Heritage Site
- ⬭ - Sewage Lagoon
- ⬭ - Waste Disposal Site

### ZONING DISTRICTS

- AR - Agricultural Resource
- CR - Country Residential
- H - Hamlet
- HPC - High Profile Commercial/Light Industrial
- IND - Industrial

### OVERLAY ZONES

- ⊕ Tatagwa Parkway District
- ▨ Environmentally Sensitive Areas

THIS IS THE ZONING DISTRICT MAP REFERRED TO IN BYLAW No. 6-2013 ADOPTED BY THE RM of WEYBURN No. 67

*Imsterley*  
REEVE  
*[Signature]*  
ADMINISTRATOR

APPROVED ON THE 12<sup>th</sup> DAY OF October, 2016

For: *[Signature]*  
MINISTER OF GOVERNMENT RELATIONS



# Rural Municipality of Weyburn No. 67

## ZONING DISTRICT MAP

Detail Map A

- Railways
- Provincial Highway
- Primary Grid Road
- Grid/Access Road
- Municipal Boundary
- Urban Municipality
- Waterbody-Drainage
- Heritage Site
- Sewage Lagoon
- Waste Disposal Site

### ZONING DISTRICTS

- AR - Agricultural Resource
- CR - Country Residential
- H - Hamlet
- HPC - High Profile Commercial/Light Industrial
- IND - Industrial

### OVERLAY ZONES

- Environmentally Sensitive Areas
- Tatagwa Parkway District

THIS IS THE ZONING DISTRICT MAP REFERRED TO IN BYLAW No. 6-2013 ADOPTED BY THE RM OF WEYBURN No. 67

*Imsterling*  
REEVE  
*[Signature]*  
ADMINISTRATOR

APPROVED ON THE 13 DAY OF October, 2015

*[Signature]* 03/14/16  
MINISTER OF GOVERNMENT RELATIONS

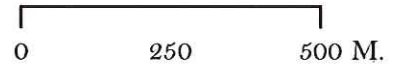
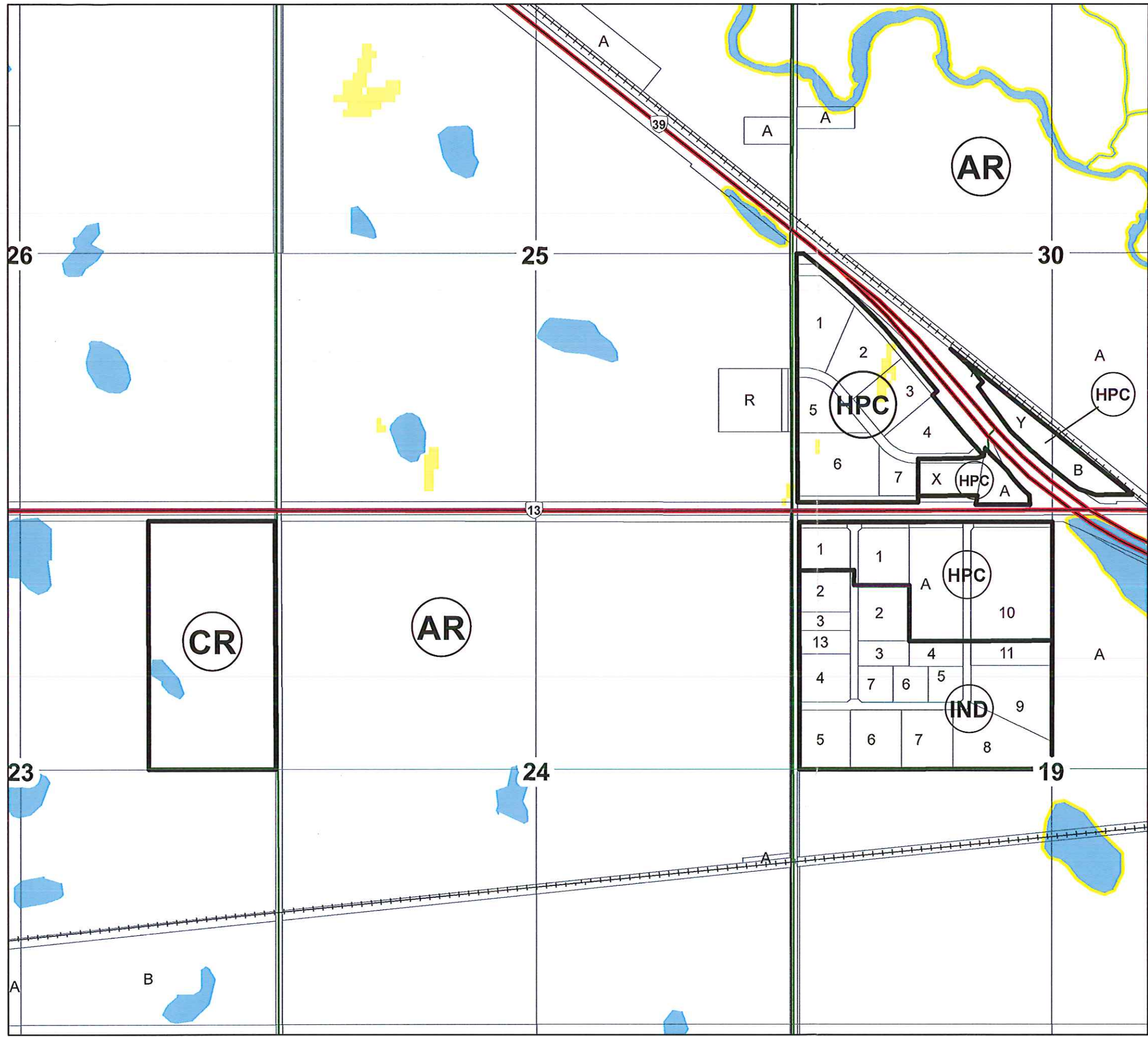

# Rural Municipality of Weyburn No. 67

## ZONING DISTRICT MAP

Detail Map B

- ++++ Railways
- Provincial Highway
- Primary Grid Road
- Grid/Access Road
- ▭ Municipal Boundary
- ▭ Urban Municipality
- ▭ Waterbody-Drainage
- ⊕ Heritage Site
- SL - Sewage Lagoon
- WD - Waste Disposal Site

### ZONING DISTRICTS

- AR - Agricultural Resource
- CR - Country Residential
- H - Hamlet
- HPC - High Profile Commercial/Light Industrial
- IND - Industrial

### OVERLAY ZONES

- ▭ Environmentally Sensitive Areas
- ⊕ Tatagwa Parkway District

THIS IS THE ZONING DISTRICT MAP REFERRED TO IN BYLAW No. 6-2013 ADOPTED BY THE RM OF WEYBURN No. 67

*Imtiaz*  
REEVE  
*J. [Signature]*  
ADMINISTRATOR

APPROVED ON THE 12<sup>th</sup> DAY OF October, 2016

*[Signature]*  
FOR: MINISTER OF GOVERNMENT RELATIONS

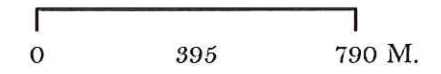
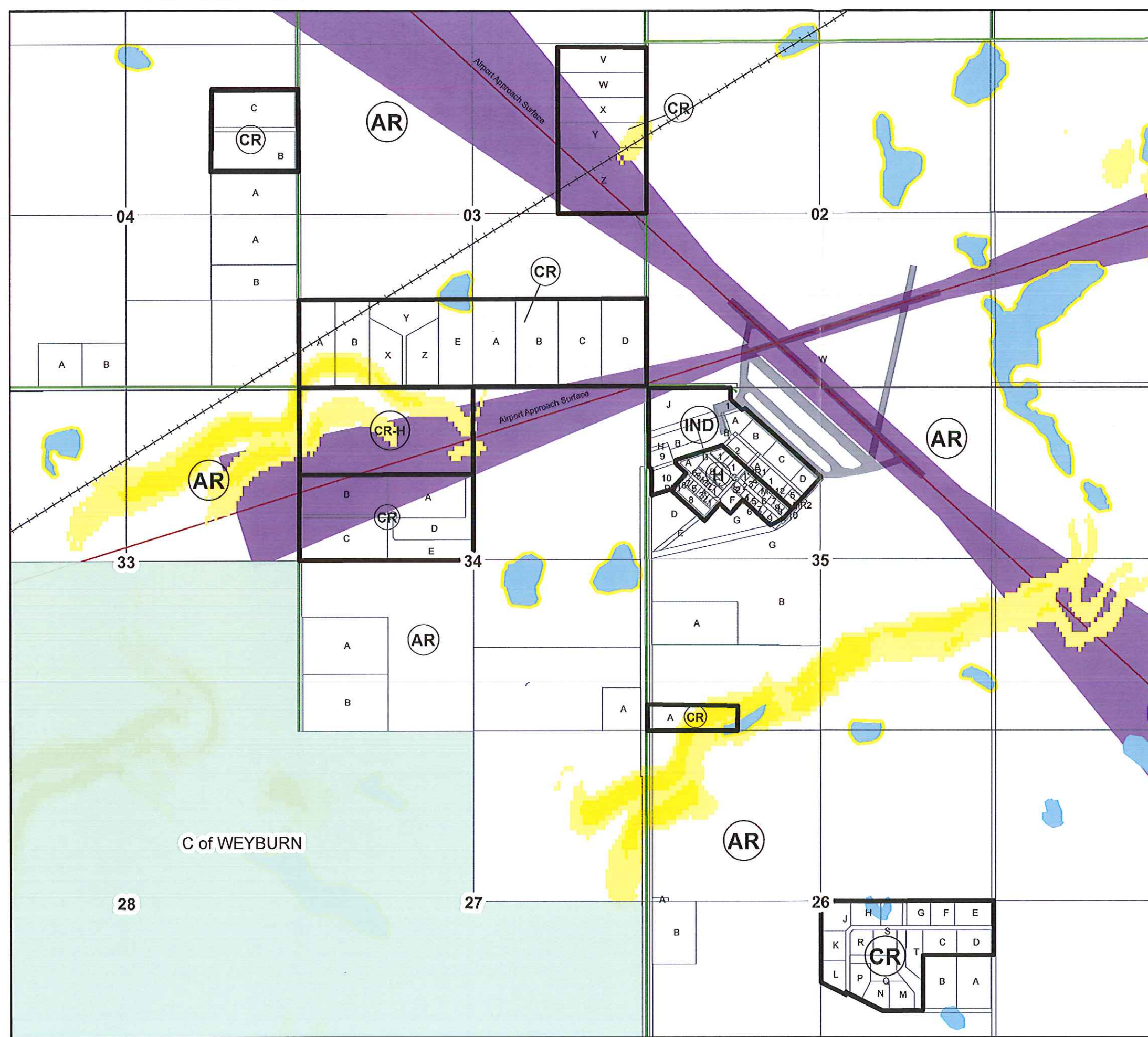

# Rural Municipality of Weyburn No. 67

## ZONING DISTRICT MAP



Detail Map C

- ++++ Railways
-  Provincial Highway
-  Primary Grid Road
-  Grid/Access Road
-  Municipal Boundary
-  Urban Municipality
-  Waterbody-Drainage
-  Heritage Site
-  SL - Sewage Lagoon
-  VD - Waste Disposal Site

### ZONING DISTRICTS

- AR - Agricultural Resource
- CR - Country Residential
- H - Hamlet
- HPC - High Profile Commercial/Light Industrial
- IND - Industrial

### OVERLAY ZONES

-  Environmentally Sensitive Areas
-  Tatagwa Parkway District

THIS IS THE ZONING DISTRICT MAP  
REFERRED TO IN BYLAW No. 6-2013  
ADOPTED BY THE RM of WEYBURN No. 67

  
REEVE  
  
ADMINISTRATOR

APPROVED ON THE 12<sup>th</sup> DAY OF October, 2016

  
For: MINISTER OF GOVERNMENT RELATIONS

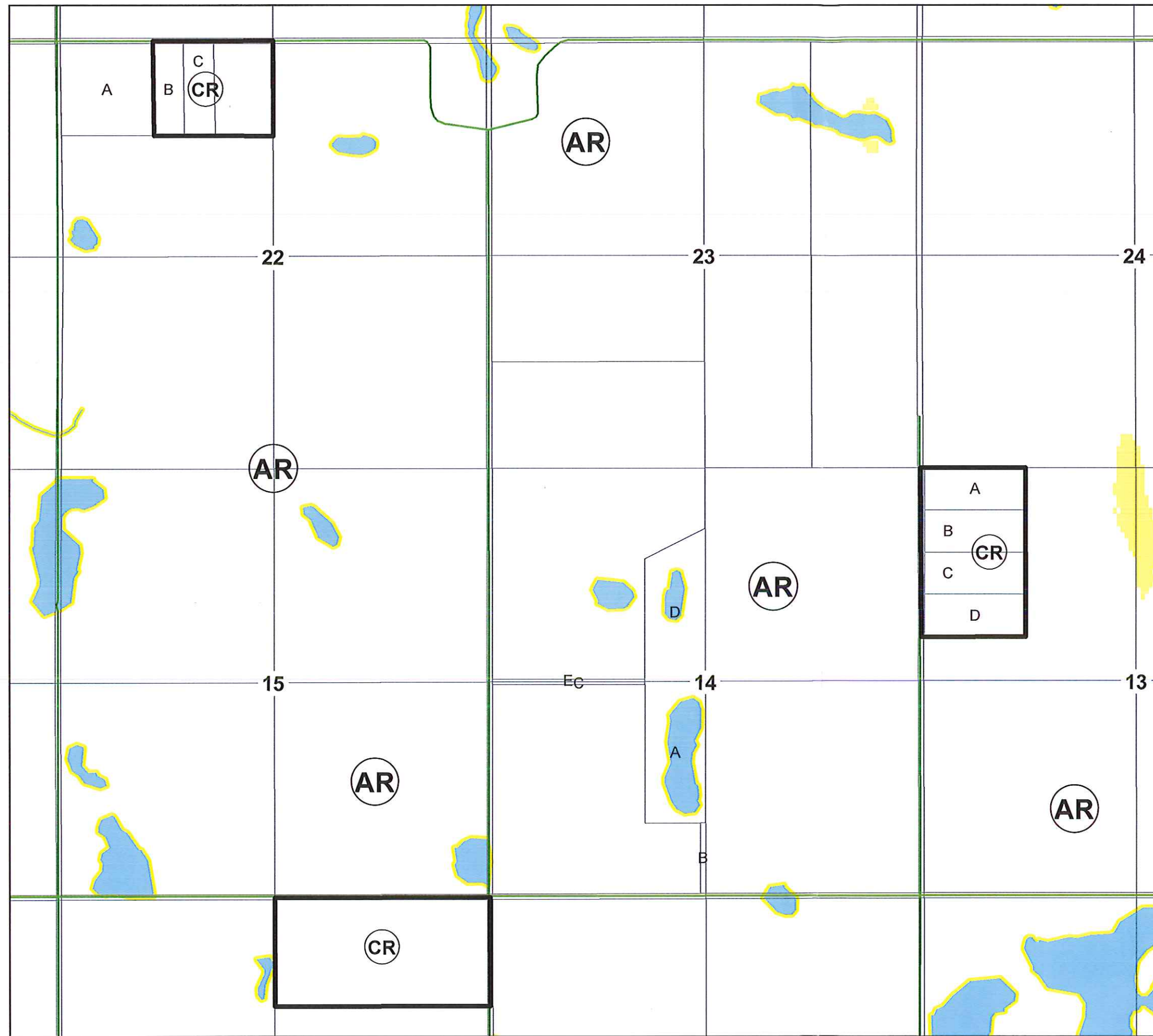

# Rural Municipality of Weyburn No. 67

## ZONING DISTRICT MAP

Detail Map D

- Railways
- Provincial Highway
- Primary Grid Road
- Grid/Access Road
- Municipal Boundary
- Urban Municipality
- Waterbody-Drainage
- Heritage Site
- Sewage Lagoon
- Waste Disposal Site

ZONING DISTRICTS

- AR - Agricultural Resource
- CR - Country Residential
- H - Hamlet
- HPC - High Profile Commercial/Light Industrial
- IND - Industrial

OVERLAY ZONES

- Environmentally Sensitive Areas
- Tatagwa Parkway District

THIS IS THE ZONING DISTRICT MAP REFERRED TO IN BYLAW No. 6-2013 ADOPTED BY THE RM OF WEYBURN No. 67

*M. Sterling*  
REEVE  
*A. Smith*  
ADMINISTRATOR

APPROVED ON THE 13 DAY OF October, 2015

*K. ...*  
03/14/16  
MINISTER OF GOVERNMENT RELATIONS

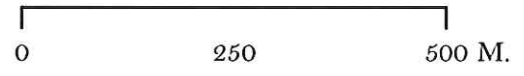
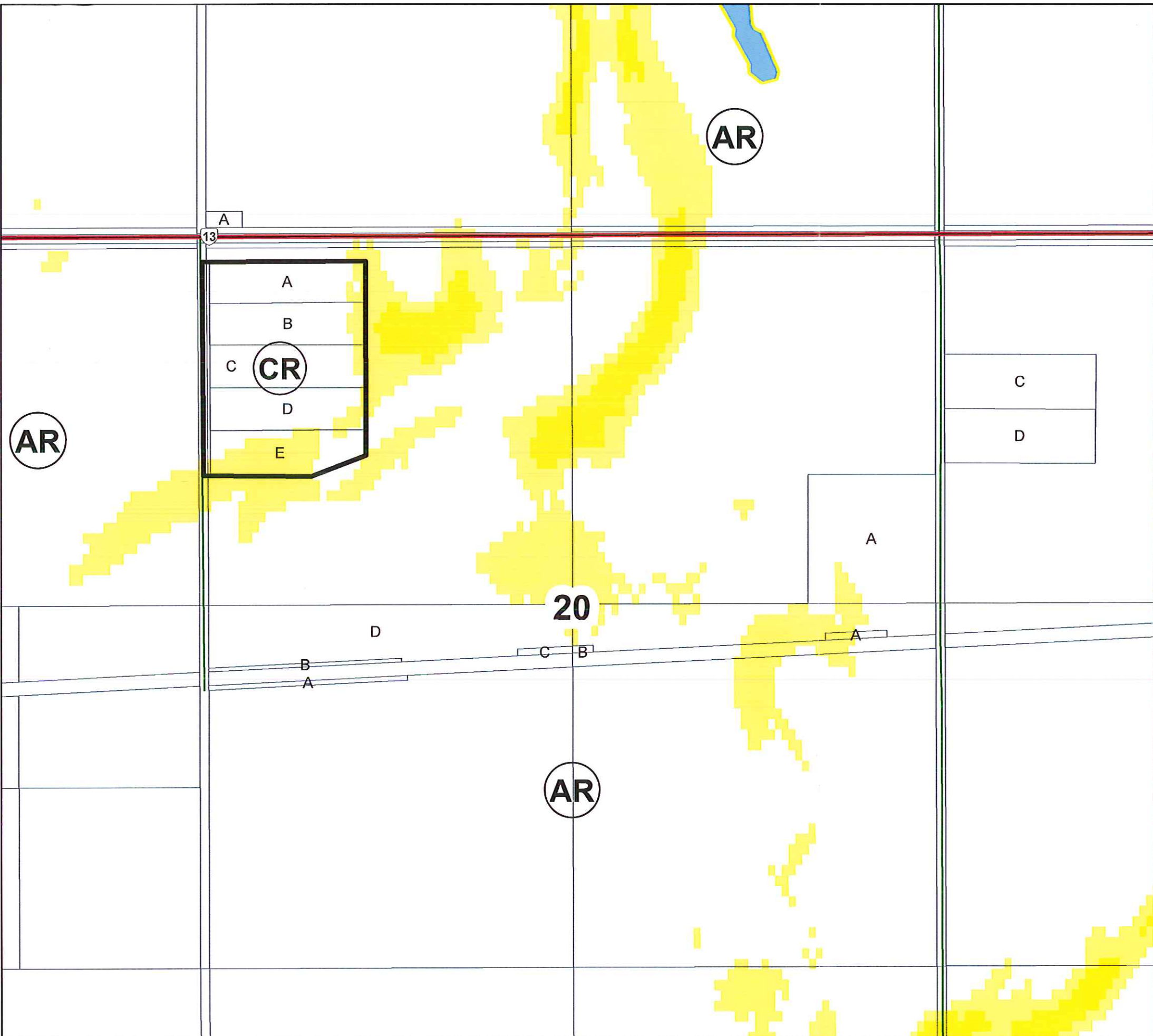

# Rural Municipality of Weyburn No. 67

## ZONING DISTRICT MAP

Detail Map E

- Railways
- Provincial Highway
- Primary Grid Road
- Grid/Access Road
- Municipal Boundary
- Urban Municipality
- Waterbody-Drainage
- Heritage Site
- SL - Sewage Lagoon
- WD - Waste Disposal Site

### ZONING DISTRICTS

- AR - Agricultural Resource
- CR - Country Residential
- H - Hamlet
- HPC - High Profile Commercial/Light Industrial
- IND - Industrial

### OVERLAY ZONES

- Environmentally Sensitive Areas
- Tatagwa Parkway District

THIS IS THE ZONING DISTRICT MAP REFERRED TO IN BYLAW No. 6-2013 ADOPTED BY THE RM of WEYBURN No. 67

*M. Steinhilber*  
REEVE  
*[Signature]*  
ADMINISTRATOR

APPROVED ON THE 13 DAY OF October, 2015

*[Signature]*  
MINISTER OF GOVERNMENT RELATIONS

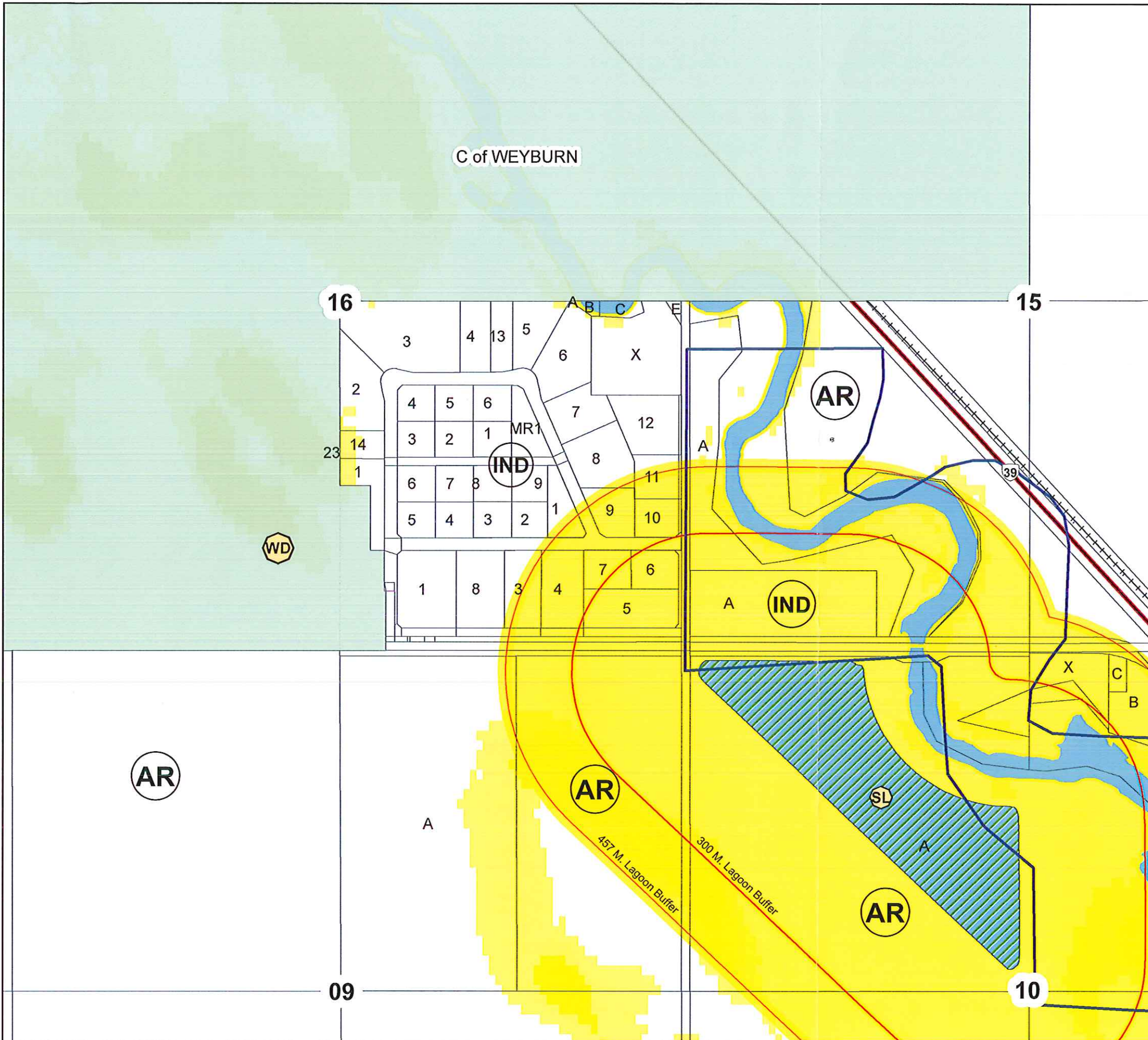
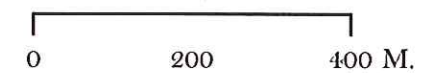

# Rural Municipality of Weyburn No. 67

## ZONING DISTRICT MAP

Detail Map F

- Railways
- Provincial Highway
- Primary Grid Road
- Grid/Access Road
- Municipal Boundary
- Urban Municipality
- Waterbody-Drainage

- Heritage Site
- SL - Sewage Lagoon
- WD - Waste Disposal Site

### ZONING DISTRICTS

- AR - Agricultural Resource
- CR - Country Residential
- H - Hamlet
- HPC - High Profile Commercial/Light Industrial
- IND - Industrial

### OVERLAY ZONES

- Environmentally Sensitive Areas
- Tatagwa Parkway District

THIS IS THE ZONING DISTRICT MAP REFERRED TO IN BYLAW No. 6-2013 ADOPTED BY THE RM OF WEYBURN No. 67

*Imsterling*  
 REVE  
*Janis Ott*  
 ADMINISTRATOR

APPROVED ON THE 12<sup>th</sup> DAY OF October, 2016

For: *[Signature]*  
 MINISTER OF GOVERNMENT RELATIONS

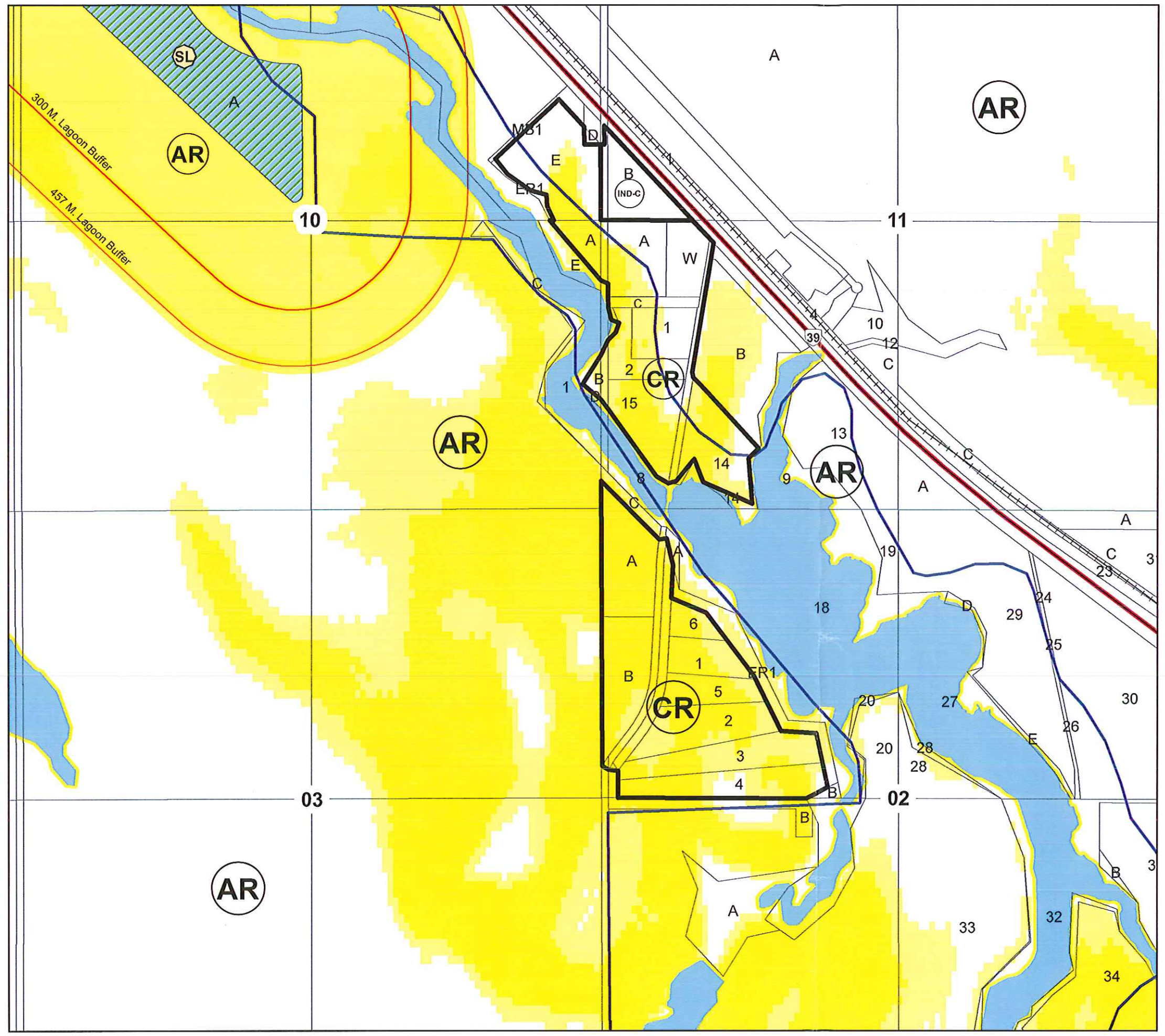
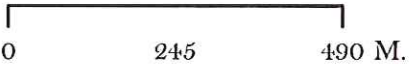

# Rural Municipality of Weyburn No. 67



## ZONING DISTRICT MAP Detail Map G

- ++++ Railways
-  Provincial Highway
-  Primary Grid Road
-  Grid/Access Road
-  Municipal Boundary
-  Urban Municipality
-  Waterbody-Drainage
-  Heritage Site
-  SL - Sewage Lagoon
-  WD - Waste Disposal Site



### ZONING DISTRICTS

- AR - Agricultural Resource
- CR - Country Residential
- H - Hamlet
- HPC - High Profile Commercial/Light Industrial
- IND - Industrial

### OVERLAY ZONES

-  Environmentally Sensitive Areas
-  Tatagwa Parkway District

THIS IS THE ZONING DISTRICT MAP REFERRED TO IN BYLAW No. 6-2013 ADOPTED BY THE RM OF WEYBURN No. 67

  
REEVE  
  
ADMINISTRATOR

APPROVED ON THE 13 DAY OF October, 2015

  
MINISTER OF GOVERNMENT RELATIONS



0 150 300 M.





# Rural Municipality of Weyburn No. 67

## ZONING DISTRICT MAP

Detail Map H

- Railways
- Provincial Highway
- Primary Grid Road
- Grid/Access Road
- Municipal Boundary
- Urban Municipality
- Waterbody-Drainage
- Heritage Site
- Sewage Lagoon
- Waste Disposal Site

### ZONING DISTRICTS

- AR - Agricultural Resource
- CR - Country Residential
- H - Hamlet
- HPC - High Profile Commercial/Light Industrial
- IND - Industrial

### OVERLAY ZONES

- Environmentally Sensitive Areas
- Tatagwa Parkway District

THIS IS THE ZONING DISTRICT MAP REFERRED TO IN BYLAW No. 6-2013 ADOPTED BY THE RM of WEYBURN No. 67

REEVE  
  
ADMINISTRATOR

APPROVED ON THE 13 DAY OF October, 2015

MINISTER OF GOVERNMENT RELATIONS

